

NOTES:  
All dimensions must be checked on site and not scaled from this drawing.

HEDGE SPECIFICATION  
60% Hawthorn (*Crataegus monogyna*)  
10% Hazel (*Corylus avellana*)  
5% Elder Rose (*Viburnum opulus*)  
5% Dogwood (*Cornus sanguinea*)  
15% Field Maple (*Acer campestre*)  
5% Holly (*Ilex aquifolium*)

TREES  
① 'ACER CAMPESTRE'  
② 'BETULA JACQUINQUETII'  
③ 'SORBUS AUCLAPARIA'  
(MINIMUM 8-10 CM GIRTH)

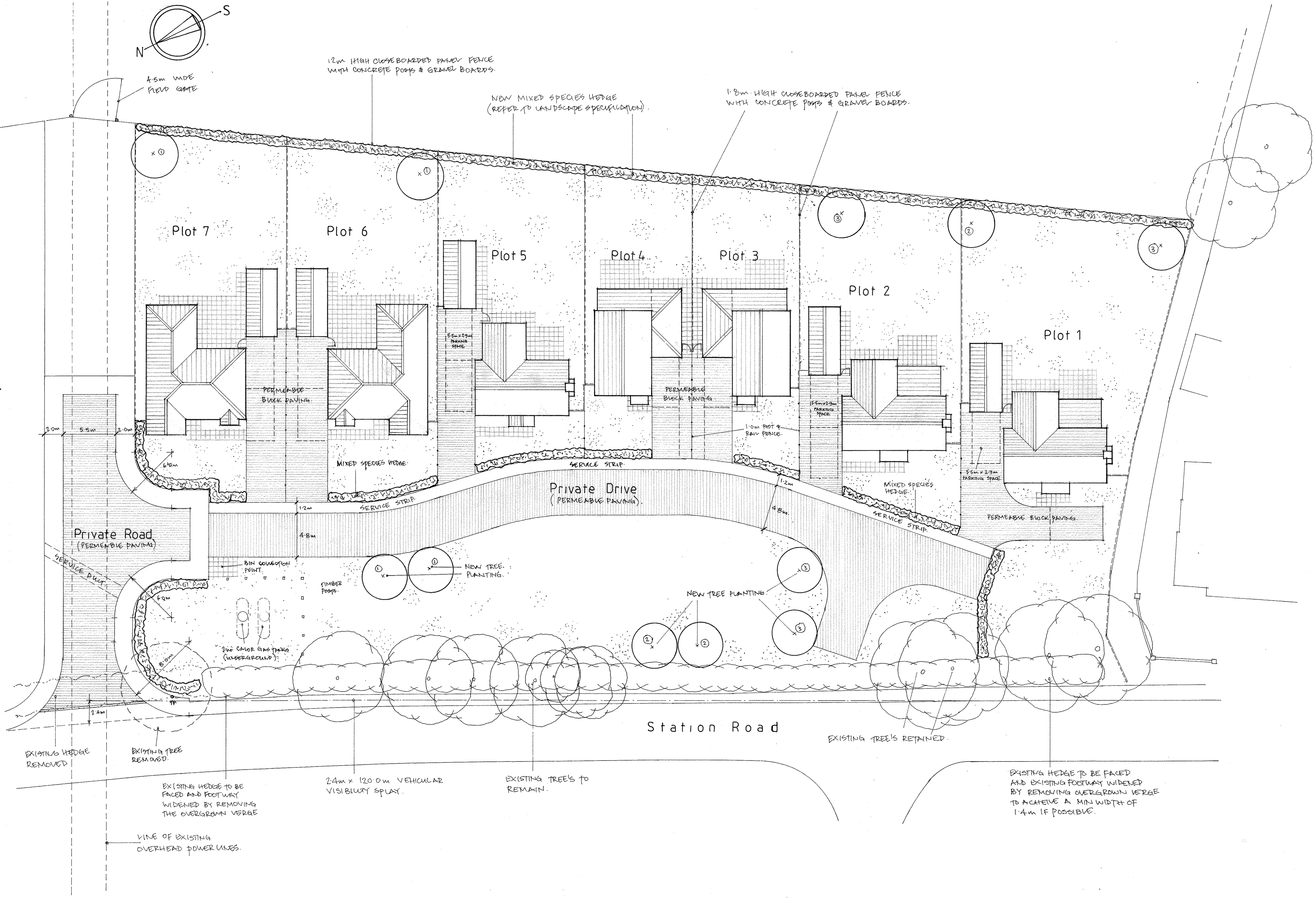

Date	Revisions
Oct '19	REMOVE TREES ON PLOTS 1-7 AMENDED
19/10/19	SERVICE STRIP ADJUSTED POSITION OF FOOT 2

© copyright

**V&B**  
**HOMES**  
VAUGHAN  
& BLYTH  
(Construction) Ltd  
Tel: 01206 791660

Client  
Rusden Ltd

Job Title  
Proposed development  
Station Road  
Thorrington

Drawing Title  
Proposed site layout  
Sheet 1

Scale 1:200

Date Oct '19 Drawn by

Drp. No. 686 / 1	Rev. B
---------------------	-----------